

RES
LIFE
ESU

— at

EMPORIA STATE
UNIVERSITY

Emporia State University Residential Life's **Vision** is to build a home of connection, belonging and legacy for you and your fellow students. Our **Mission** is to foster Hornet development through residential living that supports the individual and builds community.

Our Values

- **Development.** We believe challenges are opportunities for empowerment and progress.
- **Inclusion.** We foster inclusive spaces, hire diverse staff and facilitate learning to inspire belonging and respect that support each individual.
- **People.** Rooted in human dignity, we prioritize serving the basic needs of those in our care.
- **Environment.** We strive to maintain an atmosphere of safety and efficiency.
- **Community.** Our community is cultivated by a commitment to physical setting, mutually shared experiences, communications and trust.

Need more?

Daily campus visits offer you the chance to talk to an advisor about your future major, find out about scholarships and financial aid opportunities and see more of ESU's residential halls. Sign up at emporia.edu/visit.

home is where the ♥ is

EMPORIA STATE
UNIVERSITY

Abigail Morse Hall

Abigail Morse Hall is all the beauty of the original 1920s building, with brand-new 2020s amenities. And since it's in the heart of campus, you're never far from class, the dining hall and all the campus activities.

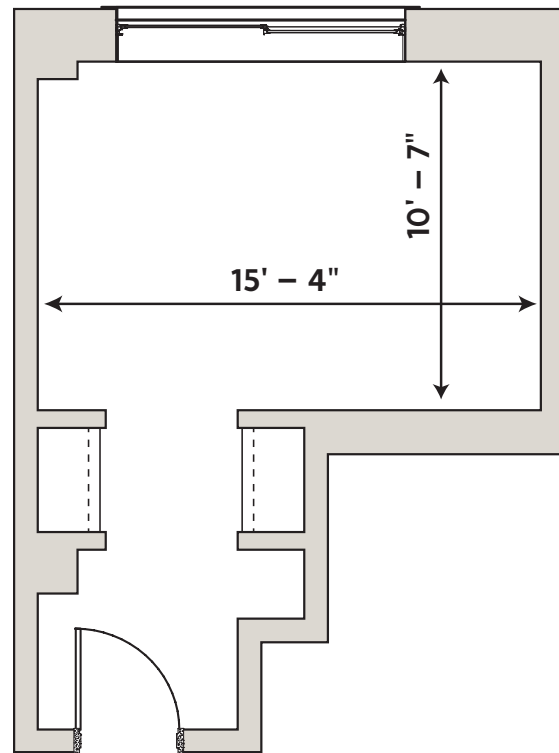

Abigail Morse

To learn more about Abigail Morse Hall and get a closer look, scan the QR code!



Schallenkamp Hall

Schallenkamp Hall, the newest residential building on campus, features walk-in closets, laundry rooms and community kitchens so you have everything you want right in your building.

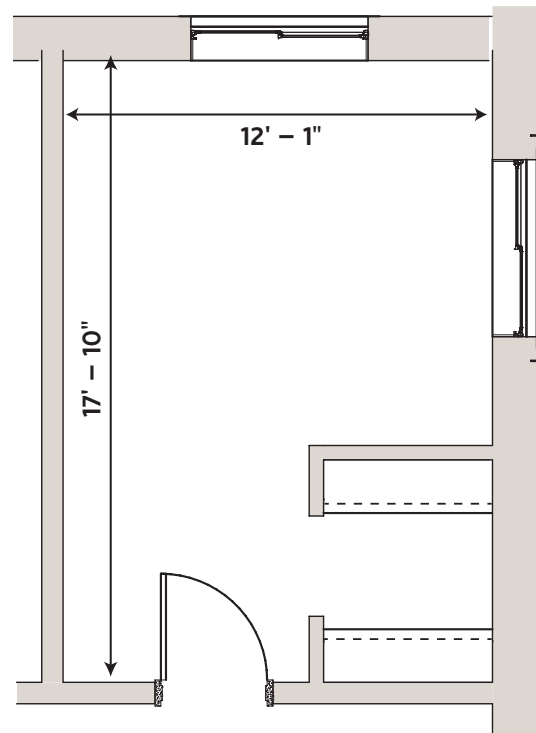

Schallenkamp Double

Also available – double room with one window and ADA Medical Private room – priority for students with accommodations through Student Accessibility and Support Services

To learn more about Schallenkamp Hall and get a closer look, scan the QR code!



Singular + Trusler Hall

Singular + Trusler Hall puts you close to the action! Just steps away from Welch Stadium, you can experience campus life by walking right out your front door.

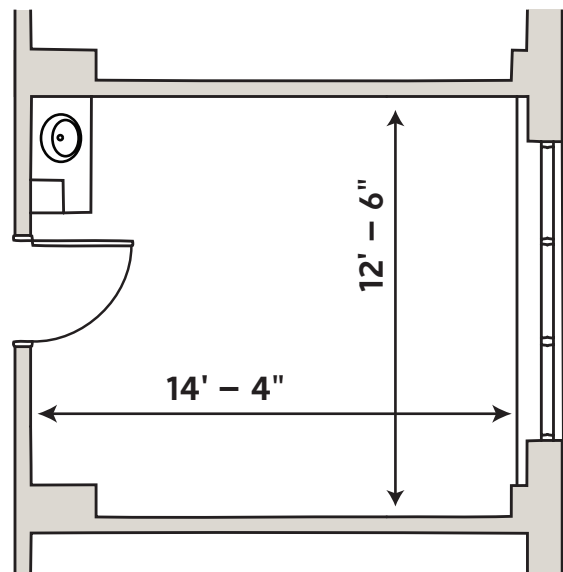

Singular & Trusler Double



To learn more about Singular and Trusler Halls and get a closer look, scan the QR code!



North + South Tower

Towers gives you options for your on-campus living. Choose a double or a suite. You even have the option of a single room!

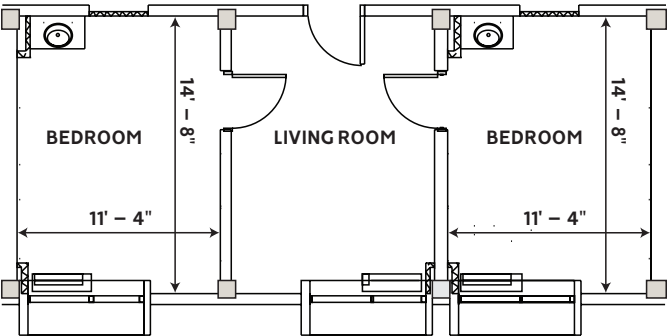

North & South Tower Suite

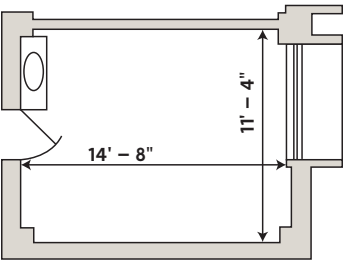

North & South Tower Single/Double



To learn more about North and South Tower and get a closer look, scan the QR code!



Find the Right Place for You

Some amenities vary by hall, but regardless of where you live, you'll be part of a community of students and staff who call Emporia State home.

	Abigail Morse	North + South Tower	Schallenkamp	Singular + Trusler
Double Room (2 Residents)				
Suite (4 Residents)				
Single Rooms				
Single-Gender Communities				
Mixed-Gender Communities				
Community Study Rooms				
In-Room Sink				
Enhanced Temperature Control				
Room Storage	Dresser + Closet	Wardrobe	Dresser + Closet	Wardrobe

Universal Features



Community Bathrooms



Wi-Fi + Ethernet

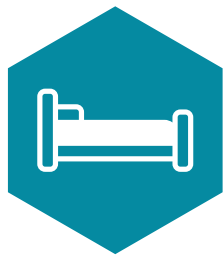

Furnished Rooms



On-site Free Laundry



Community Kitchen

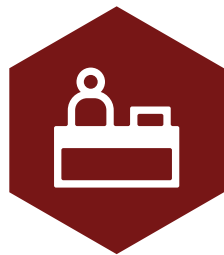

Reception Center

We know what you're thinking.

How much is all of this going to cost? For information about the finances of living on campus, scan the QR code.

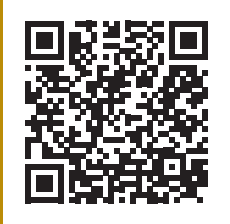

Make Connections

Our Themed Floor Communities (TFCs) foster connection, learning and personal growth through intentional experiences and interactions. TFCs allow residents with similar interests or majors to integrate living and learning. Some examples of previous TFCs include:

- Business
- Education
- College Transition
- Honors
- Diversity, Equity and Inclusion
- Nursing

Timing is everything

The housing application seems like a lot of steps to keep track of, but we're here to make it easy.

- October Housing Application part one opens. This is where you give us your contact information and let us know what hall you're hoping for.
- February Housing Application part two opens. Here you will complete the application and make your prepayment. Check emporia.edu/reslife for more information.
- May Housing Application Priority Date is May 1! Complete your application by this date to be in the first round of housing assignments.
- June/July Room and roommates are assigned. Check your student email for a notification about your room assignment, roommate pairing and information for moving in.
- August Move-in day! Stay in the loop by checking your student email, watching the Residential Life social pages and communicating with your roommate.

Dates on this page are subject to change. For more information, visit emporia.edu/reslife.



Did you know?

Residential Life has around 50 student employee positions. Not to mention, offices all around campus hire students for a number of jobs. Learn more at emporia.edu/careerservices.

Ready to apply?

Scan the QR code to get started.



You are Here

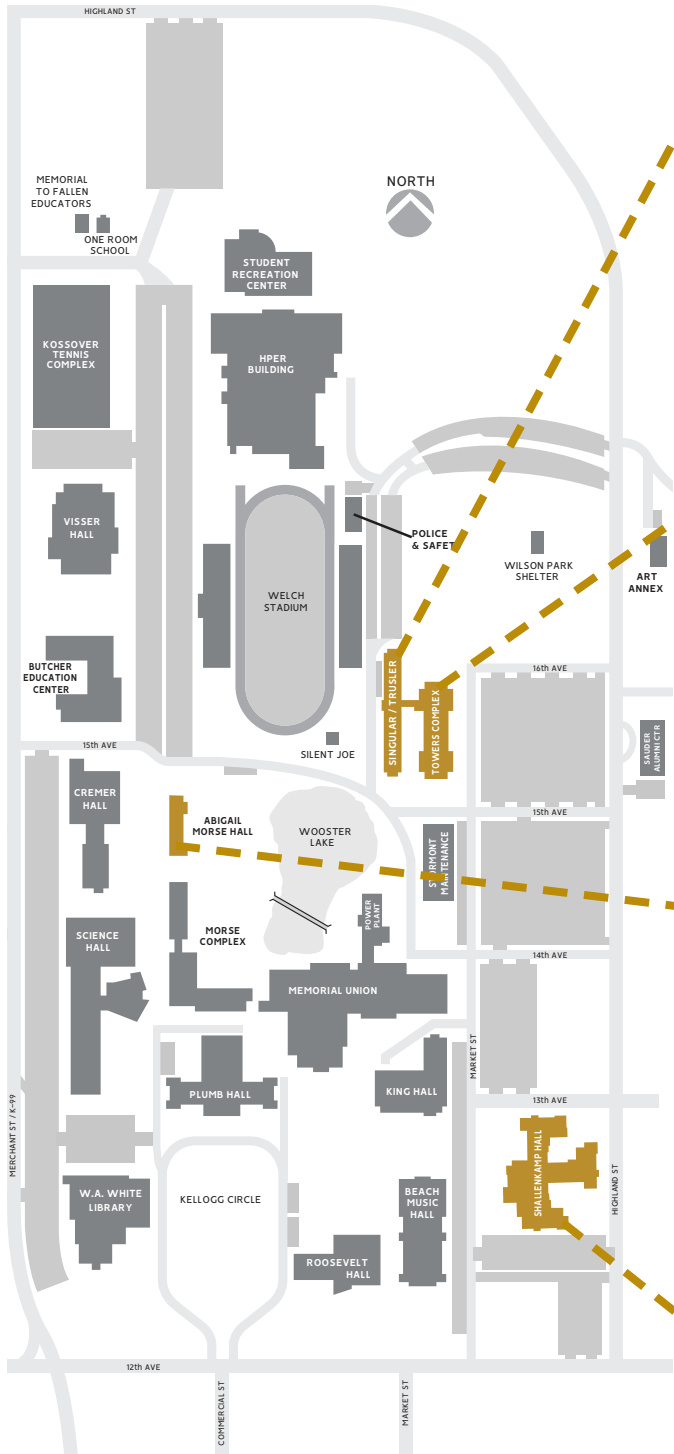

Singular + Trusler Hall



North + South Tower



Abigail Morse Hall



Schallenkamp Hall

More Things to Consider

Dine with Us

ESU Dining has multiple meal plan options for you to choose from.



Check In with the Student Wellness Center

See what information you need to provide before move-in and how they can help support your health throughout your time at ESU.

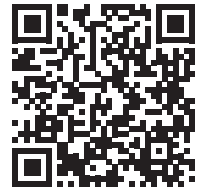

Put Yourself Out There

The Center for Student Involvement can help you meet new people and get involved on campus. Check out all the Welcome Week and Orientation events – you’ll feel right at home in no time.



But Wait, There’s More!

See all the student services available to you – from where to work out to how you can get help with your biology homework. Find it all by scanning the QR code.



EMPORIA STATE UNIVERSITY

Contact us

Residential Life

620.341.5264

reslife@emporia.edu

emporia.edu/reslife

 @ESUResLife

 @emporiastatereslife

 @esureslife

